

TO-THF2L-74	TO-THC2L-74	TO-TH2L-74
TO-THF2L-30F	TO-THC2L-30F	TO-TH2L-30F
TO-THF2L-30K	TO-THC2L-30K	TO-TH2L-30K
TO-THF2L-30X	TO-THC2L-30X	TO-TH2L-30X
TO-THF2L-30XF	TO-THC2L-30XF	TO-TH2L-30XF
TO-THF2L-30XK	TO-THC2L-30XK	TO-TH2L-30XK

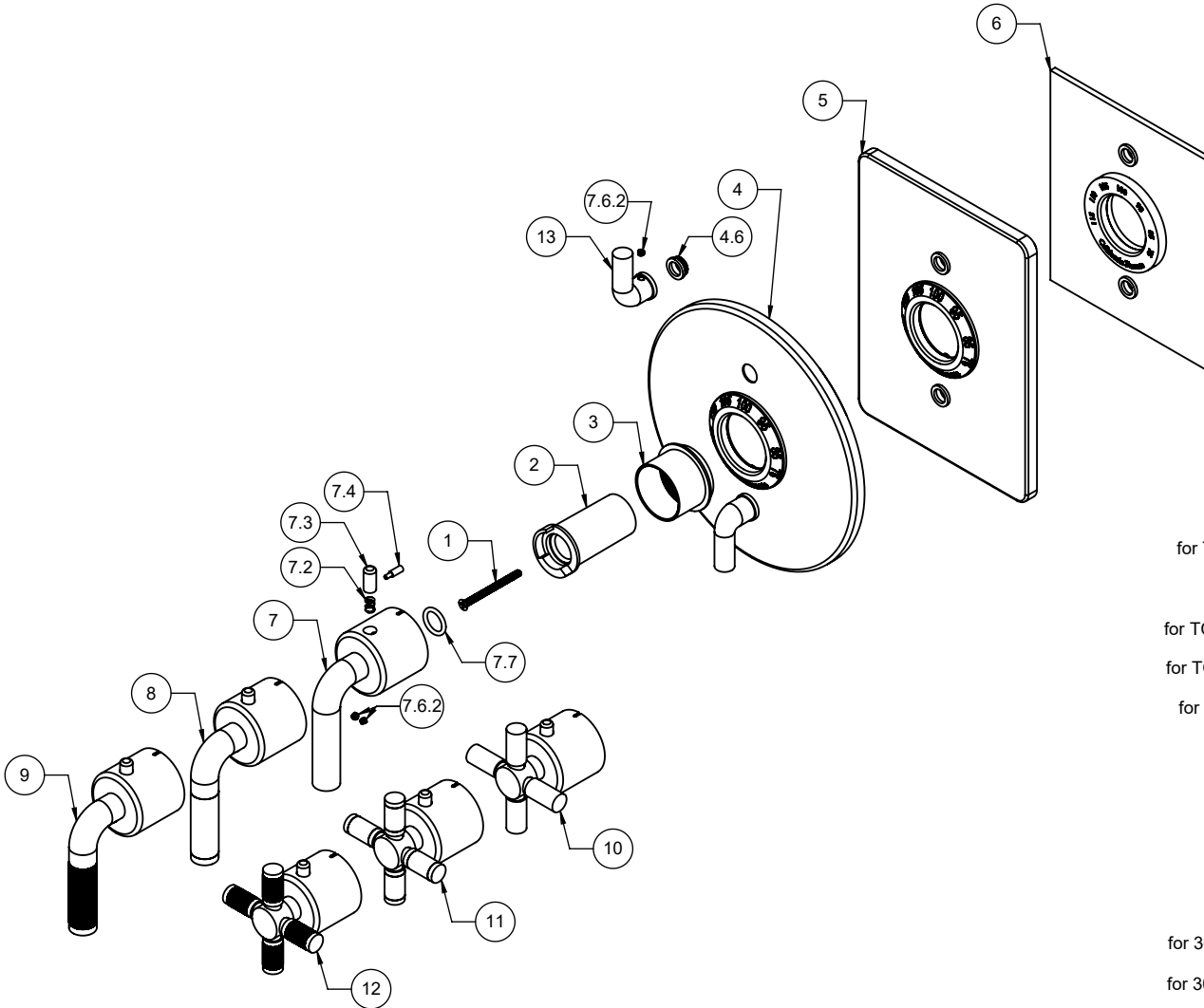

To order spare parts add and/or replace as stated below:

SPD- prefix added to part number(s)
-ZZ replaced with finish code (see finish table)
-WW replaced with **-90** (light finish) or **-96** (dark finish)

Ex: **SPD-7-100278-PC** or **SPD-86030-96**

ITEM	PART NO.	DESCRIPTION	QTY.
1	86255-90	SCREW M4 X 0.7 X 50MM PH FLT HD SS	1
2	10092-81	STOP, THERM TEMP, SHORT	1
3	10090-ZZ	SLEEVE, THERMO MOUNTING	1
for TO-TH2L	4	7-100042-ZZ ASM, SHWRPLATE, CONT RD, THERM W/2VC <i>(incl. 4.6)</i>	1
	4.6	223467-99 NYLON BUSHING FOR PBS FACEPLATE	2
for TO-THC2L	5	7-100048-ZZ ASM, SHOWERPLATE, CONT SQ. THERM W/ 2 VC <i>(incl. 4.6)</i>	1
for TO-THF2L	6	7-100240-ZZ ASM, SHWRPLATE, CONT FLAT, THERM W/2 VC <i>(incl. 4.6)</i>	1
for 74 series	7	TH-H-74-ZZ THERM HANDLE KIT <i>(incl. 7.2, 7.3, 7.4, 7.6.2, 7.7)</i>	1
	7.2	10098-99 SPRING, Ø.24 X .312 LG, 1.4 LB/IN	1
	7.3	10093-81 BUTTON, BLACK THERM	1
	7.4	10062-98 PIN, THERMO BONNET	1
	7.6.2	86030-WW SETSCREW 8-32 X 1/8 SCKT HD CUP PT SS	2
	7.7	87222-80 O-RING Ø13.94 X 2.62 (-113) EPDM A70 (NSF61-12 & WRAS)	1
for 30F series	8	TH-H-30F-ZZ THERM HANDLE KIT <i>(incl. 7.2, 7.3, 7.4, 7.6.2, 7.7)</i>	1
for 30K series	9	TH-H-30K-ZZ THERM HANDLE KIT <i>(incl. 7.2, 7.3, 7.4, 7.6.2, 7.7)</i>	1
for 30X series	10	TH-H-30X-ZZ THERM HANDLE KIT <i>(incl. 7.2, 7.3, 7.4, 7.6.2, 7.7)</i>	1
for 30XF series	11	TH-H-30XF-ZZ THERM HANDLE KIT <i>(incl. 7.2, 7.3, 7.4, 7.6.2, 7.7)</i>	1
for 30XK series	12	TH-H-30XK-ZZ THERM HANDLE KIT <i>(incl. 7.2, 7.3, 7.4, 7.6.2, 7.7)</i>	1
	13	7-100181-ZZ ASM, THERM VC - MODERN <i>(incl. 7.6.2)</i>	2
for ITEM 7.6.2	14	882042-99 KEY, ALLEN, 5/64", BLACK	1